

Technical data sheet

Product features



Multifunctional kitchen appliance INFINITY 10x GN 2/1

| | | |
|--------------|-----------------|----------|
| Model | SAP Code | 00010710 |
|--------------|-----------------|----------|



- Shock cooling cycle kg / min (+3 ° C): 70/90
- Shock freeze cycle kg / min (-18 ° C): 50/240
- Maximum device temperature [°C]: -40
- Probe: 4-points
- Insulation thickness [mm]: 80
- Control type: Touchscreen
- Display size: 9"
- User programmable cycles: Yes, with save options
- Thaving cycle: Yes
- Proving cycle: Yes

| | | | |
|----------------------------|--------------------|--|-------------|
| SAP Code | 00010710 | Number of GN / EN | 10 |
| Net Width [mm] | 790 | GN / EN size in device | GN 1/1 |
| Net Depth [mm] | 839 | GN device depth | 65 |
| Net Height [mm] | 1650 | Shock cooling cycle kg / min (+3 ° C) | 70/90 |
| Net Weight [kg] | 179.00 | Shock freeze cycle kg / min (-18 ° C) | 50/240 |
| Power electric [kW] | 2.390 | Control type | Touchscreen |
| Loading | 400 V / 3N - 50 Hz | | |

Technical data sheet

Technical drawing



Multifunctional kitchen appliance INFINITY 10x GN 2/1

Model

SAP Code

00010710

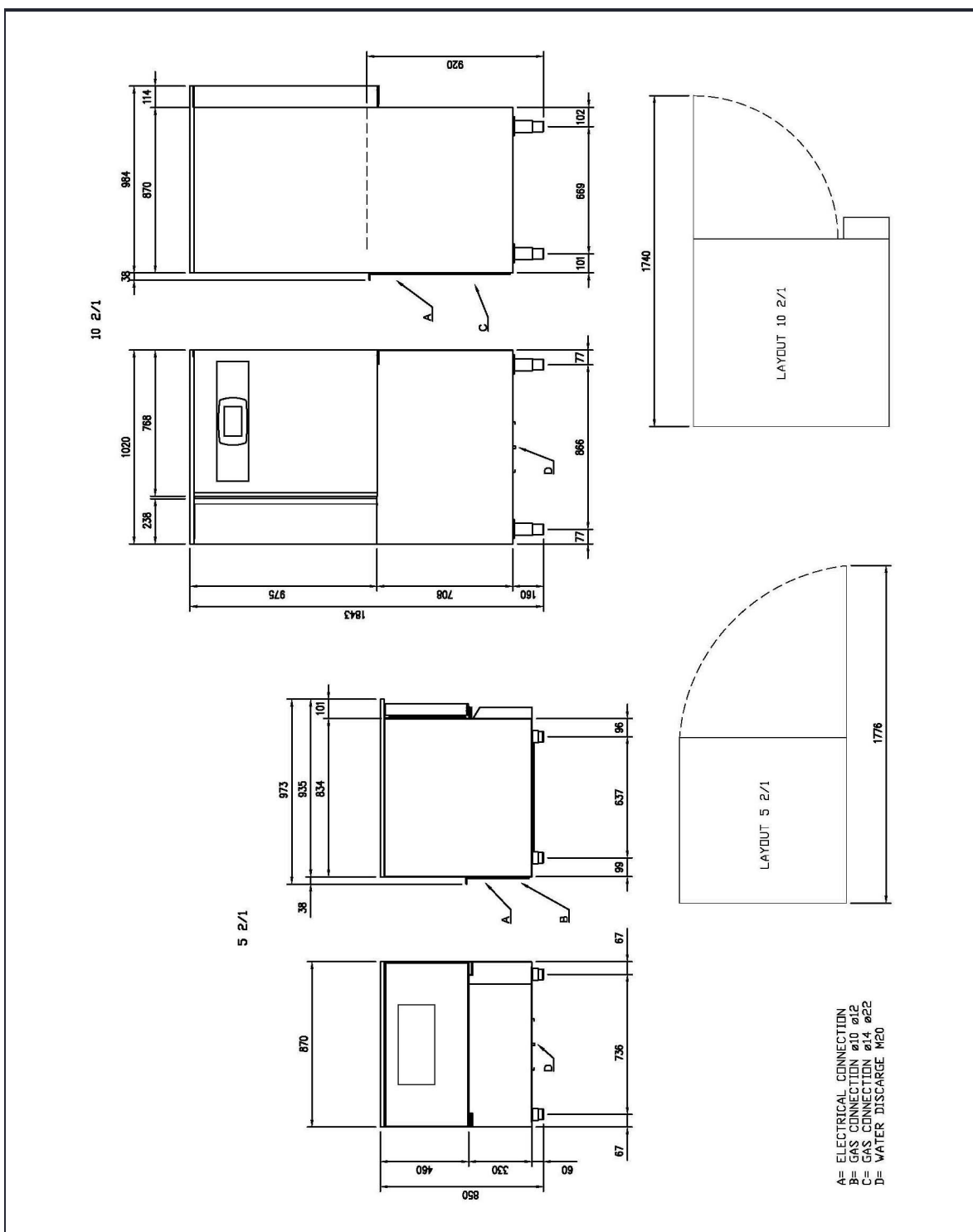

Technical data sheet

Product benefits



Multifunctional kitchen appliance INFINITY 10x GN 2/1

Model

SAP Code

00010710

1

6 in 1

can replace 6 devices (fridge, freezer, shocker, hotbox, kitchen, oven)

- saves space, time, energy and the cost of additional equipment due to the enormous variability

2

Stainless steel body and interior

endurance
hygiene

- thanks to the all-stainless steel construction it is very easy to maintain and thus saves costs

3

Monitoring of HACCP parameters

easy registration of all necessary parameters

- hassle-free proof of proper food handling in the event of an inspection

4

Preset cycles

very simple and intuitive operation

- operation can be handled by less qualified operators

5

Slow cooking

better taste
less weight loss during cooking

- saves costs due to less weight loss

6

Multipoint probe

precise monitoring of the cooling/freezing/
cooking temperature

- the probe makes it easier to ensure food safety
- saves energy and time due to the end of cooling/freezing/cooking when temperature is reached

7

Thawing

readiness of frozen food for processing on time

- time saving
- controlled food handling

8

Cooking during the night

the possibility to preset entire program cycles and run them overnight unattended

- saving equipment capacity during the day
- saving of human capacity and time due to unattended operation of the equipment overnight

Technical data sheet

Technical parameters



Multifunctional kitchen appliance INFINITY 10x GN 2/1

| Model | SAP Code | 00010710 |
|-------|----------|----------|
|-------|----------|----------|

1. SAP Code:

00010710

2. Net Width [mm]:

790

3. Net Depth [mm]:

839

4. Net Height [mm]:

1650

5. Net Weight [kg]:

179.00

6. Gross Width [mm]:

846

7. Gross depth [mm]:

860

8. Gross Height [mm]:

1780

9. Gross Weight [kg]:

189.70

10. Device type:

Electric unit

11. Material:

AISI 304

12. Exterior color of the device:

Stainless steel

13. Opening of device:

Hinges on the right

14. Power electric [kW]:

2.390

15. Loading:

400 V / 3N - 50 Hz

16. Control type:

Touchscreen

17. Display size:

9"

18. Refrigerant:

R452a

19. Number of GN / EN:

10

20. GN / EN size in device:

GN 1/1

21. GN device depth:

65

22. Maximum device temperature [°C]:

-40

23. Shock freeze cycle kg / min (-18 ° C):

50/240

24. Shock cooling cycle kg / min (+3 ° C):

70/90

25. Insulation thickness [mm]:

80

26. Long-term cooling function:

Yes

27. Longterm freezing function:

Yes

28. Probe:

4-points

Technical data sheet

Technical parameters



Multifunctional kitchen appliance INFINITY 10x GN 2/1

Model

SAP Code

00010710

29. Self-diagnostics:

Yes

30. Interior lighting:

Yes

31. HACCP:

Yes

32. Low temperature heat treatment:

Yes

33. Low temperature cooking span [°C]:

52-85

34. Thaving cycle:

Yes

35. Proving cycle:

Yes

36. User programmable cycles:

Yes, with save options

37. USB port:

Yes, for HACCP and firmware update

38. Castors:

Optional

39. Real time monitoring paramaters:

Energy consumption, Chamber temperature, Probe temperature, Graph with the course of temperature and consumption

40. Cross-section of conductors CU [mm²]:

0,5

- Výkon (kW): 2,4-3,3 (230 V)